



至臻服务 · 诚信经营
Serve Diligently · Operate Faithfully



地址：四川省成都市双流区西南航空港经济开发区空港四路2618号
ADD：No. 2618, 4th Konggang Road, Southwest Airport Economic
Development Zone, Chengdu City, Sichuan, P. R. China.
网站：Http：//www.santonccst.com Http：//www.carbidebladesc.com
电话/TEL：+86-28-85739522 +86-28-85739369
传真/FAX：+86-28-85739559
邮箱/Email：sales_1@santoncc.com
邮编/P.C：610200



西顿微信公众号

硬质合金立装刀片

Cemented Carbide Indexable Milling Inserts



成都西顿硬质合金有限公司
CHENGDU SANTON CEMENTED CARBIDE CO.,LTD
中国·四川
SICHUAN CHINA



Company profile 公司简介 >>

成都西顿硬质合金有限公司成立于2007年1月，位于成都市双流区西南航空港经济开发区空港四路2618号，占地面积20亩，是一家专业从事硬质合金和钨钼产品等有色金属新材料研发、生产和销售为一体的高新技术企业，公司已获得17项专利（实用新型专利11项，发明专利6项）。

公司聚集了一批技术功底过硬、管理经验丰富的本专业人才和高素质的生产骨干队伍，采用国际先进的石蜡生产工艺与精确控碳专利技术，配备有先进的生产设备和质量检测手段，能满足客户对硬质合金、钨钼制品等产品的高品质、高性价比的要求。

公司具有较强的自主研发、设计和生产能力，在国内同行企业中率先通过了英国UKAS公司的ISO9001质量管理体系、环境管理体系和职业健康安全管理体系认证。公司本着“臻臻服务、诚信经营”的经营理念，为用户提供富有技术含量和应用价值的售前、售中和售后服务。公司生产的“西顿”牌高性能硬质合金立装刀片、曲轴专用铣削刀片、轨道专用铣削刀片、齿轮专用铣削刀片、转子专用铣削刀片等，以良好的信誉、优良的品质和热忱的服务，深受国内外用户信任和欢迎。

公司秉承“自强不息、志存高远、以人为本、和谐发展”的企业精神和“质量立业、技术领先、持续改进、顾客满意”的质量方针，力求为社会创造价值，为客户增加价值、为员工实现价值、用我们的勤劳和智慧，促进企业持续发展，共同创造美好未来。

Chengdu Santon Cemented Carbide Co., Ltd. was established in January, 2007, which is located in No.2618, Konggang 4th Road, Southwest Airport Economic Development Zone, Shuangliu District, Chengdu, covering an area of 15,000 square meters. Santon is a high-tech enterprise, integrating research and development, production and sales of new nonferrous metal material products including cemented carbide, and tungsten-molybdenum alloy, etc. Santon has obtained 17 patents (11 utility model patents, and 6 invention patents). Santon has gathered a team of professional experienced personnel for strong technical support as well as management and production. Equipped with advanced production equipments and quality inspection methods, by means of advanced paraffin production and accurate control of carbon content technology, Santon can meet customers' requirements for high quality and cost-effective products such as carbide, tungsten and molybdenum alloy, etc. Santon has strong independent research and development, design and production capabilities. It has passed several management system certifications by UKAS company, including ISO9001 international quality, ISO14001 environment and OHSAS 18001 occupational health and safety. Santon persists in the business philosophy 'serving diligently, operate faithfully', to provide clients with professional and valuable pre-sales, in-sales and after-sales services in terms of technology and application. Thanks to high performances, excellent quality, dedicated services, and good reputation, Santon brand has been deeply trusted and warmly welcomed by customers from all over the world, our main products consist of carbide indexable milling inserts, special crankshaft machining milling inserts, track milling inserts, gear milling inserts, and rotor milling inserts, etc. Santon adheres to the enterprise spirit 'self-motivation, high aspirations, people oriented, harmonious development', and quality policy 'quality foundation, technology leadership, continuous improvement, customer satisfaction'. We strive to create value for society, to increase value for customers, and to achieve value for employees. With our diligence and wisdom, we will promote the sustainable development of enterprises and jointly create a better future.

专注于立装刀片采购一站式解决方案

Focus on offering turnkey solutions to carbide indexable milling insert procurement

目录 Contents

牌号性能及用途
Grade performances and applications
page 01~03

轨道专用铣削刀片
Crack milling inserts
page 04~05

曲轴专用铣削刀片
Crankshaft milling inserts
page 06~08

齿轮专用铣削刀片
Gear milling inserts
page 09~10

重力铣削专用刀片
Heavy milling inserts
page 11~16

主要生产设备简介
Main production facilities introduction
page 17

西顿科技成果
Santon technology achievements
page 19



成都西顿硬质合金有限公司

CHENGDU SANTON CEMENTED CARBIDE CO., LTD.



牌号性能及用途介绍
Grade performances and applications

涂层 牌号 Coated Grade	使用性能及用途介绍 Performances & Applications	相当于国际标准 Equivalent to ISO
ST2410	PVD 涂层, 灰黑色: 红硬性高与韧性好的刀刃基体与 TiAlN 的涂层结合, 特别适用于钢、铸钢的高速精加工。TiAlN ash black PVD coated on carbide substrate with high red hardness and good toughness, especially for high speed finishing of steel and cast steel.	P01-P15
ST2135	CVD 涂层, 金黄色: 强度与韧性特高的刀刃基体与 TiC、Al ₂ O ₃ 、TiN 等涂层材料的最佳组合, 是钢材粗加工的通用牌号, 特别适用于铸钢和锻钢的重型粗加工。Multi-layered(TiC/Al ₂ O ₃ /TiN) golden CVD coated on extra high strength and toughness carbide substrate, a universal grade for steel roughing, especially for heavy roughing of cast steel and forged steel.	P25-P45
ST1420	PVD 涂层, 灰黑色: 耐磨性与韧性很好的刀刃基体与 TiAlN 的涂层结合, 特别适用于钛、铝、铜等及其合金, 冷硬铸铁, 以及亚克力、塑料、石墨、耐火砖等非金属材料切削加工。TiAlN base ash black PVD coated on extra superior tough and wear resistant carbide substrate, particularly for cutting of titanium, aluminum, copper and brass, chilled cast iron, and non-metal materials such as Acrylic, plastic, graphite, refractory brick, etc.	K10-K20
ST1430	CVD 涂层, 黑色: 韧性好的刀刃基体与 TiN、TiCN、Al ₂ O ₃ 涂层结合, 适合于铸件, 合金钢粗加工。Multi-layered (TiN/TiCN/Al ₂ O ₃) black CVD coated on good toughness carbide substrate, suitable for roughing of forgings and alloy steel.	K20-K30
ST2230	MT-CVD 涂层, 金黄色: 特殊强度与韧性的刀刃基体与 TiC、TiCN、TiN 等涂层材料的最佳组合, 是钢材加工的通用牌号, 适用于钢、铸钢的一般加工和粗加工。Golden multi-layered MT-CVD (TiC/TiCN/TiN) coated on special strength and toughness carbide substrate, a general purpose grade for steel cutting, general cutting and roughing for steel and cast steel.	P20-P35
ST1420	PVD 涂层, 灰黑色: 耐磨性与韧性很好的刀刃基体与 TiAlN 的涂层结合, 特别适用于钛、铝、铜等及其合金, 冷硬铸铁, 以及亚克力、塑料、石墨、耐火砖等非金属材料的精加工和半精加工。TiAlN base ash black PVD coated on carbide substrate with excellent toughness and wear resistance, especially for finishing and semi-finishing of titanium, aluminum, copper and brass, chilled cast iron, and non-metal materials such Acrylic, plastic, graphite, refractory brick, etc.	K01-K10
ST2415	PVD 涂层, 灰黑色: 耐磨性与韧性好的刀刃基体与 TiAlN 的涂层结合, 特别适用于扩张强度高的钢、铸钢的精加工和半精加工。TiAlN base ash black PVD coated on carbide substrate with good toughness and wear resistance, particularly for finishing and semi-finishing of high expansion strength steel and cast steel.	P10-P25
ST3420	PVD 涂层, 灰黑紫色: 强度、韧性好的基体与 TiAlN 的涂层结合, 是不锈钢加工的首选牌号。TiAlN base ash black purple PVD coated on good strength and toughness carbide substrate, first choice for stainless steel cutting.	M10-M25
ST3430	PVD 涂层, 灰黑紫色: 强度、韧性好的基体与 TiAlN 等涂层的组合, 是不锈钢断续加工和粗加工的理想牌号。TiAlN base ash black purple PVD coated on good strength and toughness carbide substrate, ideal for roughing and interrupted cutting of stainless steel.	M10-M35

本样本中的牌号有首选和可选之分, 表示方法为:
▲首选 First choice △可选 Second choice



牌号性能及用途介绍
Grade performances and applications

未涂层 牌号 Uncoated Grade	性能典型值 Typical property Values			使用性能及用途 Performances and Applications	ISO 分类 ISO Code	国内厂家 类似牌号 Other Chinese similar grades
	密度 (g/cm ³)	抗弯强度 TRS (N/mm ²)	硬度 HRA			
ST2020	11.5	1650	91.8	使用强度高, 抗冲击韧性好。适合于钢、铸钢, 可锻铸铁, 及球墨铸铁的半精加工或浅粗加工。 High impact resistance and strength. Suitable for shallow roughing and semi-finishing of steel, cast steel, forgeable cast iron and nodular cast iron.	P15	YT798 YT14 ZP20
ST2025	12.3	1920	92.2	韧性好, 具有很高的抗热震裂和抗塑性变形能力。适于铣削合金结构钢、合金工具钢, 也适于高锰钢、不锈钢的加工。 Good toughness, excellent resistance to thermal crack and plastic deformation. Suitable for milling of alloy structure steel, alloy steel, high manganese steel, and stainless steel.		
ST2030	12.6	1950	91.5	适用于碳钢、铸钢、锰钢、高强度及各种合金钢的粗车, 铣削刨削和深孔加工, 同时也是制作深孔加工导料块的理想材料。 Suitable for rough turning, milling, planning, and deep-drilling of carbon steel, cast steel, manganese steel, high-tensile steel, and various alloy steels. An ideal material for deep-drilling guide block.		
ST2035	12.7	2220	91.0	红硬性好, 并且有良好的抗冲击及抗热震性和高的使用强度, 是通用性良好的牌号。适用于钢及铸钢的粗加工的强力切削。 A excellent universal grade, good red hardness, high strength, good resistance to impact and thermal shock. Suitable for roughing, and strong cutting of steel and cast steel.	P25	ZP25 YT535 ZP30 ZP35
					P	
					P25	
					P35	YT5 YC30 YS25 YS30



牌号性能及用途介绍

Grade performances and applications

未涂层 牌号 Uncoated Grade	性能典型值 Typical property Values			使用性能及用途 Performances and Applications	ISO 分类 ISO Code	国内厂家 类似牌号 Other Chinese similar grades
	密度 (g/cm ³)	抗弯强度 TRS (n/mm ²)	硬度 HRA			
ST2040	13.0	2280	90.5	在P类合金中, 强度、抗冲击性及抗震性最好。适于碳素钢与合金钢(包括锻件、冲压件、铸铁表皮)间断切削的粗车、粗刨、半精刨。 Best strength, best resistance to impact and thermal shock among W-Co-Ti alloys. Suitable for rough turning, rough planning, and half precision planning of carbon steel, and alloy steel(including forgings, stamped parts, and cast iron surfaces)during the interrupted cutting.	P	ZP40 YC40
ST2045	14.3	2800	89.0	韧性好, 具有很高的抗热震裂和抗塑性变形能力。适于铣削合金结构钢, 合金钢, 也适于高锰钢, 是加工转子的理想材质。 Good toughness, high resistance to thermal shock and plastic deformation. Suitable for milling of alloy steel, alloy structure steel as well as high manganese steel, an ideal material for rotors machining.	P40	YC45 YT540
ST1010	14.8	2500	93.2	适用于各种铸铁及有色金属的精加工和半精加工, 也是制作整体硬质合金孔加工工具的理想材料。 Suitable for semi-finishing, and finishing of cast irons and non-ferrous metals. It is also the ideal material of making solid carbide tools for hole machining.	K05 - K10	ZK10UF YG6X YG6A ZK10 YG10.1 YD10.2 YD05
ST1030	14.4	2600	91.5	超细合金, 使用强度高, 抗冲击, 抗震性好。适于铸铁、有色金属及合金、非金属材料低速粗加工。 Ultra-fine alloy, high strength, good resistance to impact and thermal shock. Suitable for low speed roughing of cast iron, non-ferrous metals, alloys, and non-metallic materials.	K K20 - K30	YD201 ZK30UF YG546 YG813 YD20 YG8

轨道专用铣削刀片

Crack milling inserts

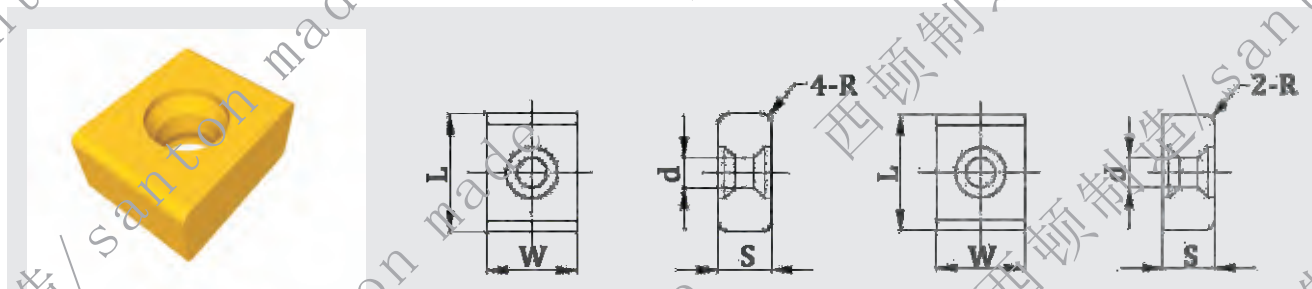

Type 型号	Dimension (mm) 基本尺寸						Coated Grade 涂层牌号						Uncoated Grade 非涂层牌号					
	L	W	S	d	R		ST2135	ST2230	ST2415	ST2410	ST3420	ST3430	ST1430	ST1420	ST1410	ST2020	ST2025	ST2030
LNEC151207-4R1	15.875	12.7	7.94	5.5	1		▲		▲			▲	▲			△	△	
LNEC151207-4R2	15.875	12.7	7.94	5.5	2		▲		▲			▲	▲			△	△	
LNEC151207-4R3	15.875	12.7	7.94	5.5	3		▲		▲			▲	▲			△	△	
LNEC151207-2R2	15.875	12.7	7.94	5.5	2		▲		▲			▲	▲			△	△	
LNEC151207-2R3	15.875	12.7	7.94	5.5	3		▲		▲			▲	▲			△	△	

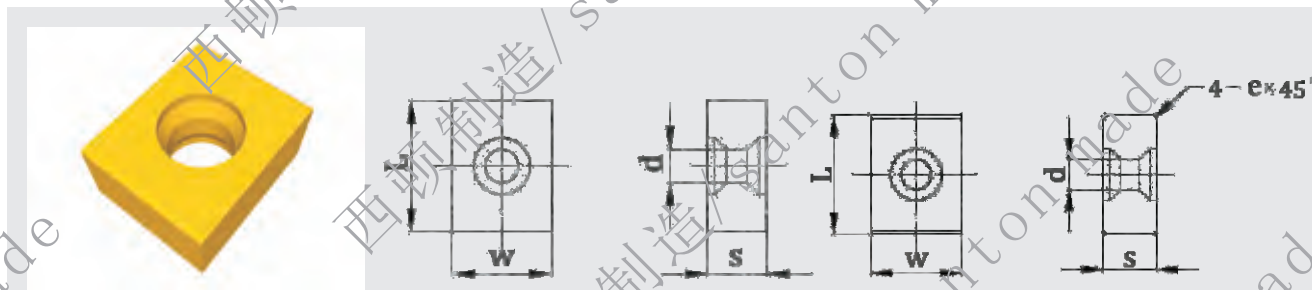

Type 型号	Dimension (mm) 基本尺寸						Coated Grade 涂层牌号						Uncoated Grade 非涂层牌号					
	L	W	S	d	e		ST2135	ST2230	ST2415	ST2410	ST3420	ST3430	ST1430	ST1420	ST1410	ST2020	ST2025	ST2030
LNEC151207	15.875	12.7	7.94	5.5			▲		▲			▲	▲			△	△	
LNEQ151207	15.875	12.7	7.94	5.5			▲		▲			▲	▲			△	△	
LNEC151207-4e0.4	15.875	12.7	7.94	5.5	0.4		▲		▲			▲	▲			△	△	
LNEQ151207-4e0.4	15.875	12.7	7.94	5.5	0.4		▲		▲			▲	▲			△	△	



轨道专用铣削刀片

Crack milling inserts

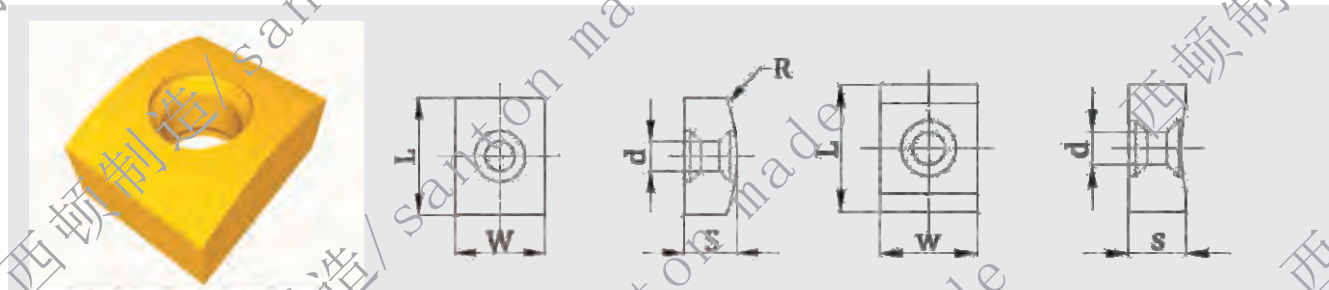

Type 型号	Dimension (mm) 基本尺寸						Coated Grade 涂层牌号								Uncoated Grade 非涂层牌号								
	L	W	S	d	DR	NR	ST2135	ST2230	ST2415	ST2410	ST3420	ST3430	ST1430	ST1420	ST1410	ST2020	ST2025	ST2030	ST2035	ST2040	ST2045	ST1010	ST1030
LNEC151207-DR11.5	15.875	12.7	7.94	5.5	11.5		▲		▲			▲	▲			△	△			△		△	
LNEC151207-DR13	15.875	12.7	7.94	5.5	13		▲		▲			▲	▲			△	△			△		△	
LNEC151207-DR14.5	15.875	12.7	7.94	5.5	14.5		▲		▲			▲	▲			△	△			△		△	
LNEC151207-DR16	15.875	12.7	7.94	5.5	16		▲		▲			▲	▲			△	△			△		△	
LNEC151207-DR20	15.875	12.7	7.94	5.5	20		▲		▲			▲	▲			△	△			△		△	
LNEC151207-DR25	15.875	12.7	7.94	5.5	25		▲		▲			▲	▲			△	△			△		△	
LNEC151207-DR40	15.875	12.7	7.94	5.5	40		▲		▲			▲	▲			△	△			△		△	
LNEC151207-DR80	15.875	12.7	7.94	5.5	80		▲		▲			▲	▲			△	△			△		△	
LNEC151207-NR10	15.875	12.7	7.94	5.5		10	▲		▲			▲	▲			△	△			△		△	
LNEC151207-2NR10	15.875	12.7	7.94	5.5		10	▲		▲			▲	▲			△	△			△		△	
LNEC151207-NR13	15.875	12.7	7.94	5.5		13	▲		▲			▲	▲			△	△			△		△	
LNEC151207-2NR13	15.875	12.7	7.94	5.5		13	▲		▲			▲	▲			△	△			△		△	
LNEC151207-2NR16	15.875	12.7	7.94	5.5		16	▲		▲			▲	▲			△	△			△		△	
LNEC151207-NR14	15.875	12.7	7.94	5.5		14	▲		▲			▲	▲			△	△			△		△	
LNEC151207-2NR14	15.875	12.7	7.94	5.5		14	▲		▲			▲	▲			△	△			△		△	
LNEC151207-NR15	15.875	12.7	7.94	5.5		15	▲		▲			▲	▲			△	△			△		△	
LNEC151207-NR80	15.875	12.7	7.94	5.5		80	▲		▲			▲	▲			△	△			△		△	
LNEC151207-2NR300	15.875	12.7	7.94	5.5		30	▲		▲			▲	▲			△	△			△		△	



曲轴专用铣削刀片

Crankshaft milling inserts



Type 型号	Dimension (mm) 基本尺寸					Coated Grade 涂层牌号									Uncoated Grade 非涂层牌号							
	L	W	S	d	R	ST2135	ST2230	ST2415	ST2410	ST3420	ST3430	ST1430	ST1420	ST1410	ST2020	ST2025	ST2030	ST2035	ST2040	ST2045	ST1010	ST1030
LNEC151207-2R3	15.875	12.7	7.94	5.5	3	▲		▲			▲	▲			△	△			△		△	
LNEC151207-2R3.5	15.875	12.7	7.94	5.5	3.5	▲		▲			▲	▲			△	△			△		△	
LNEC151207-2R4	15.875	12.7	7.94	5.5	4	▲		▲			▲	▲			△	△			△		△	
LNEC151207-2R4.5	15.875	12.7	7.94	5.5	4.5	▲		▲			▲	▲			△	△			△		△	
LNEC151207-2R5	15.875	12.7	7.94	5.5	5	▲		▲			▲	▲			△	△			△		△	
LNEC151207-2R5.5	15.875	12.7	7.94	5.5	5.5	▲		▲			▲	▲			△	△			△		△	



Type 型号	Dimension (mm) 基本尺寸					Coated Grade 涂层牌号									Uncoated Grade 非涂层牌号									
	L	W	S	R	d			ST2135	ST2230	ST2415	ST2410	ST3420	ST3430	ST1430	ST1420	ST1410	ST2020	ST2025	ST2030	ST2035	ST2040	ST2045	ST1010	ST1030
LNEC151207-4R5	15.875	12.7	7.94	5	5.5			▲	▲				▲	▲			△	△			△		△	
LNEC151206-4R4	15.875	12.7	6.35	4	5.5			▲		▲			▲	▲			△	△			△		△	
LNEC151206D-4R4	15.875	12.7	6.35	4	5.5			▲		▲			▲	▲			△	△			△		△	
LNEC151207D-4R5	15.875	12.7	7.94	5	5.5			▲		▲			▲	▲			△	△			△		△	
LNEC151207D-4R5.5	15.875	12.7	7.94	5.5	5.5			▲		▲			▲	▲			△	△			△		△	
LNEC151207D-4R6.5	15.875	12.7	7.94	6.5	5.5			▲		▲			▲	▲			△	△			△		△	
LNEC151207D-4R4	15.875	12.7	7.94	4	5.5			▲		▲			▲	▲			△	△			△		△	
LNEC181206D-4R5	18.47	12.7	6.35	5	5.5			▲		▲			▲	▲			△	△			△		△	



曲轴专用铣削刀片

Crankshaft milling inserts

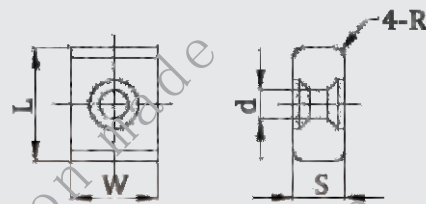

Type 型号	Dimension (mm) 基本尺寸						Coated Grade 涂层牌号								Uncoated Grade 非涂层牌号								
	L	W	S	R	d		ST2135	ST2230	ST2415	ST2410	ST3420	ST3430	ST1430	ST1420	ST1410	ST2020	ST2025	ST2030	ST2035	ST2040	ST2045	ST1010	ST1030
LNEQ150904-4R3	15.875	9.525	4.76	3	4.4		▲		▲			▲	▲			△	△			△		△	
LNEQ151104-4R3	15.875	11.00	4.76	3	5.5		▲		▲			▲	▲			△	△			△		△	
LNEQ151206-4R5	15.875	12.7	6.35	5	5.5		▲		▲			▲	▲			△	△			△		△	

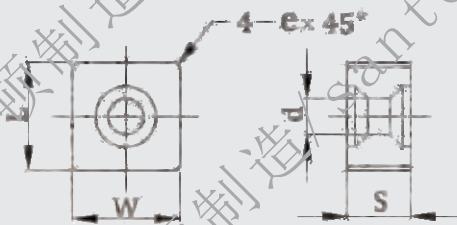

Type 型号	Dimension (mm) 基本尺寸							Coated Grade 涂层牌号						Uncoated Grade 非涂层牌号										
	L	W	S	d	e			ST2135	ST2230	ST2415	ST2410	ST3420	ST3430	ST1430	ST1420	ST1410	ST2020	ST2025	ST2030	ST2035	ST2040	ST2045	ST1010	ST1030
SNEQ1206-4e0.5	12.7	12.7	6.35	5.5	0.5			▲		▲			▲	▲			△	△			△		△	
SNEQ1206-4e0.5	12.7	12.7	6.35	5.5	0.5			▲		▲			▲	▲			△	△			△		△	
SNEQ12A06-4e0.3	12.0	12.0	6.35	5.5	0.3			▲		▲			▲	▲			△	△			△		△	
SNEQ1206-4e0.5	12.7	12.7	6.35	5.5	0.5			▲		▲			▲	▲			△	△			△		△	
SNEQ1206-4e0.5	12.7	12.7	6.35	5.5	0.5			▲		▲			▲	▲			△	△			△		△	
SNEQ12A06-4e0.3	12.0	12.0	6.35	5.5	0.3			▲		▲			▲	▲			△	△			△		△	
SNEQ12A06-4e0.5	12.0	12.0	6.35	5.5	0.5			▲		▲			▲	▲			△	△			△		△	



曲轴专用铣削刀片

Crankshaft milling inserts

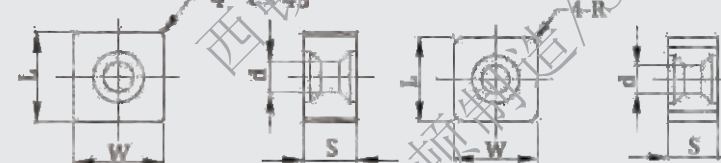

Type 型号	Dimension (mm) 基本尺寸						Coated Grade 涂层牌号						Uncoated Grade 非涂层牌号										
	L	W	S	d	R	e	ST2135	ST2230	ST2415	ST2410	ST3420	ST3430	ST1430	ST1420	ST1410	ST2020	ST2025	ST2030	ST2035	ST2040	ST2045	ST1010	ST1030
SNEQ1206-4e0.3	12.7	12.7	6.35	5.5		0.3																	
SNEQ1206-4e0.8	12.7	12.7	6.35	5.5		0.8																	
SNEQ120602-4R0.2	12.7	12.7	6.35	5.5	0.2																		
SNEQ120604-4R0.4	12.7	12.7	6.35	5.5	0.4																		
SNEQ120608-4R0.8	12.7	12.7	6.35	5.5	0.8																		

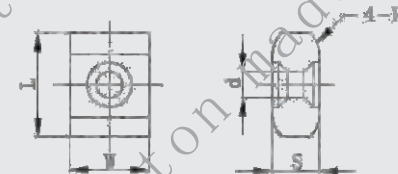

Type 型号	Dimension (mm) 基本尺寸						Coated Grade 涂层牌号						Uncoated Grade 非涂层牌号											
	L	W	S	d	R		ST2135	ST2230	ST2415	ST2410	ST3420	ST3430	ST1430	ST1420	ST1410	ST2020	ST2025	ST2030	ST2035	ST2040	ST2045	ST1010	ST1030	
SNEX0904-4R3	9.525	9.525	4.76	5.5	3		▲		▲			▲	▲			△	△				△		△	

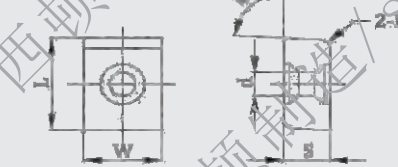

Type 型号	Dimension (mm) 基本尺寸							Coated Grade 涂层牌号							Uncoated Grade 非涂层牌号								
	L	W	S	a	β	d	R	ST2135	ST2230	ST2415	ST2410	ST3420	ST3430	ST1430	ST1410	ST2020	ST2025	ST2030	ST2035	ST2040	ST2045	ST1010	ST1030
XNEQ151207A-2R4	15.875	12.7	7.15	5.5	88°	5.5	4	▲		▲			▲	▲		△	△			△		△	
XNEQ151207A-2R2.7	15.875	12.7	7.15	5.5	88°	5.5	2.7	▲		▲			▲	▲		△	△			△		△	
XNEQ151207A-2R4.7	15.875	12.7	7.15	5.5	88°	5.5	4.7	▲		▲			▲	▲		△	△			△		△	



齿轮专用铣削刀片

Gear milling inserts

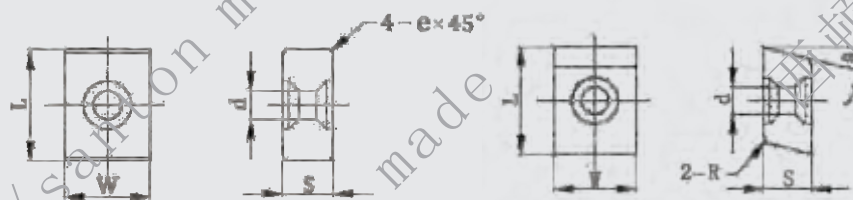

Type 型号	Dimension (mm) 基本尺寸						Coated Grade 涂层牌号						Uncoated Grade 非涂层牌号											
	L	W	S	φ	d	R	ST2135	ST2230	ST2415	ST2410	ST3420	ST3430	ST1430	ST1420	ST1410	ST2020	ST2025	ST2030	ST2035	ST2040	ST2045	ST1010	ST1030	
LNEC191406	19.05	14.3	6.35		5.5	0	▲		▲			▲	▲			△	△			△		△		
LNEC191406-4e2	19.05	14.3	6.35		5.5	0.2	▲		▲			▲	▲			△	△			△		△		
LNEC281409	28.6	14.3	6.35		5.5	0	▲		▲			▲	▲			△	△			△		△		
LNEC191207A-2R2	19.05	12.7	7.15	23°	5.5		▲		▲			▲	▲			△	△			△		△		
LNEC191406-2R2	19.05	14.3	6.35	15°	5.5		▲		▲			▲	▲			△	△			△		△		
LNEQ191405-2R2.5	19.05	14.3	5	23°	5.5	2.5	▲		▲			▲	▲			△	△			△		△		
LNEQ191406-2R2.5	19.05	14.3	6.35	23°	5.5	2.5	▲		▲			▲	▲			△	△			△		△		

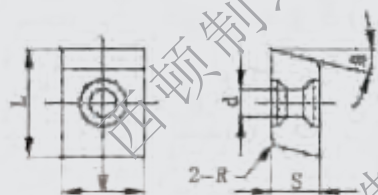

Type 型号	Dimension (mm) 基本尺寸						Coated Grade 涂层牌号						Uncoated Grade 非涂层牌号										
	L	W	S	d	R		ST2135	ST2230	ST2415	ST2410	ST3420	ST3430	ST1430	ST1420	ST1410	ST2020	ST2030	ST2035	ST2040	ST2045	ST1010	ST1030	
LNEC191408-2R3.5	19.05	14.3	8.5	20°	5.5	3.5	▲		▲			▲	▲			△	△			△		△	



齿轮专用铣削刀片

Gear milling inserts

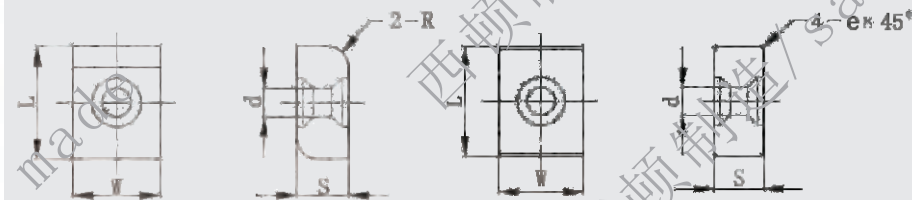

Type 型号	Dimension (mm) 基本尺寸						Coated Grade 涂层牌号							Uncoated Grade 非涂层牌号									
	L	W	S	d	R	e	ST2135	ST2230	ST2415	ST2410	ST3420	ST3430	ST1430	ST1420	ST1410	ST2020	ST2025	ST2030	ST2035	ST2040	ST2045	ST1010	ST1030
LNEX191406-2R2.4	19.05	14.3	6.35	5.5	2.4		▲		▲			▲	▲			△	△			△		△	
LNEX191406-4e0.4	19.05	14.3	6.35	5.5		0.4	▲		▲			▲	▲			△	△			△		△	
LNEX1914-4e0.8	19.05	14.3	6.35	5.5		0.8	▲		▲			▲	▲			△	△			△		△	

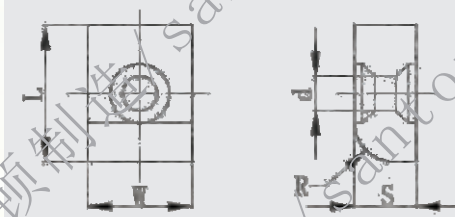

Type 型号	Dimension (mm) 基本尺寸						Coated Grade 涂层牌号						Uncoated Grade 非涂层牌号										
	L	W	S	d	R		ST2135	ST2230	ST2415	ST2410	ST3420	ST3430	ST1430	ST1420	ST1410	ST2020	ST2025	ST2030	ST2035	ST2040	ST2045	ST1010	ST1030
LNEC151207-1R7	15.875	12.7	7.94	5.5	7		▲		▲		▲	▲	▲			△	△		△		△		△
LNEC151207-1R18	15.875	12.7	7.94	5.5	18		▲		▲		▲	▲	▲			△	△		△		△		△



重力铣削专用刀片

Heavy milling inserts

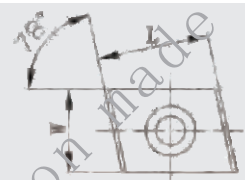

Type 型号	Dimension (mm) 基本尺寸						Coated Grade 涂层牌号								Uncoated Grade 非涂层牌号									
	L	W	S	D	R		ST2135	ST2230	ST2415	ST2410	ST3420	ST3430	ST1430	ST1420	ST1410	ST2020	ST2025	ST2030	ST2035	ST2040	ST2045	ST1010	ST1030	
CDE212R01	11.1	7.9	3.8				▲		▲			▲	▲			△	△			△		△		
CDE212L01	11.1	7.9	3.8				▲		▲			▲	▲			△	△			△		△		
CDE313R01	14.3	9.525	4.76				▲		▲			▲	▲			△	△			△		△		
CDE313L01	14.3	9.525	4.76				▲		▲			▲	▲			△	△			△		△		
CDE322L14	13.9	9.525	3.8				▲		▲			▲	▲			△	△			△		△		
CDE322R01	12.7	9.525	3.8				▲		▲			▲	▲			△	△			△		△		
CDE322L01	12.7	9.525	3.8				▲		▲			▲	▲			△	△			△		△		
CDE322R04	12.7	9.525	3.8				▲		▲			▲	▲			△	△			△		△		
CDE322R05	12.7	9.525	3.8				▲		▲			▲	▲			△	△			△		△		
CDE322L05	12.7	9.525	3.8				▲		▲			▲	▲			△	△			△		△		
CDE322LKH03	12.7	9.525	3.8				▲		▲			▲	▲			△	△			△		△		
CDE322LKH03T13	12.7	9.525	3.8				▲		▲			▲	▲			△	△			△		△		
CDE323R05	12.7	9.525	4.76				▲		▲			▲	▲			△	△			△		△		
CDE323L05	12.7	9.525	4.76				▲		▲			▲	▲			△	△			△		△		
CDE333R01	17.5	11.1	4.76				▲		▲			▲	▲			△	△			△		△		
CDE334R01	19.05	9.525	6.35				▲		▲			▲	▲			△	△			△		△		
CDE334R04	19.05	9.525	6.35				▲		▲			▲	▲			△	△			△		△		



Type 型号	Dimension (mm) 基本尺寸						Coated Grade 涂层牌号						Uncoated Grade 非涂层牌号											
	L	W	S				ST2135	ST2230	ST2415	ST2410	ST3420	ST3430	ST1430	ST1420	ST1410	ST2020	ST2025	ST2030	ST2035	ST2040	ST2045	ST1010	ST1030	
CNE323	12.7	9.525	4.76				▲		▲			▲	▲			△	△			△		△		
CNE323-R0.8	12.7	9.525	4.76				▲		▲			▲	▲			△	△			△		△		
CNE44	12.7	12.7	6.35				▲		▲			▲	▲			△	△			△		△		
CNE44-R0.8	12.7	12.7	6.35				▲		▲			▲	▲			△	△			△		△		
CNE454	16.3	14.3	6.35				▲		▲			▲	▲			△	△			△		△		

重力铣削专用刀片

Heavy milling inserts

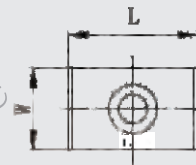

Type 型号	Dimension (mm) 基本尺寸						Coated Grade 涂层牌号						Uncoated Grade 非涂层牌号											
	L	W	S	D	R		ST2135	ST2230	ST2415	ST2410	ST3420	ST3430	ST1430	ST1420	ST1410	ST2020	ST2025	ST2030	ST2035	ST2040	ST2045	ST1015	ST1030	
LNE322-K05PH12	15.875	9.525	3.97				▲		▲			▲	▲			△	△			△		△		
LNE323-K05PH12	15.875	9.525	4.76				▲		▲			▲	▲			△	△			△		△		
LNE323-02	15.875	9.525	4.76				▲		▲			▲	▲			△	△			△		△		
LNE424R01	15.875	12.7	6.35				▲		▲			▲	▲			△	△			△		△		
LNE434-02	19.05	14.3	6.35				▲		▲			▲	▲			△	△			△		△		
LNE446R01	28.6	14.3	9.525				▲		▲			▲	▲			△	△			△		△		
LNE446L01	28.6	14.3	9.525				▲		▲			▲	▲			△	△			△		△		

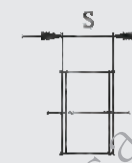
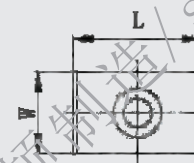

Type 型号	Dimension (mm) 基本尺寸						Coated Grade 涂层牌号						Uncoated Grade 非涂层牌号											
	L	W	S	D	R		ST2135	ST2230	ST2415	ST2410	ST3420	ST3430	ST1430	ST1420	ST1410	ST2020	ST2025	ST2030	ST2035	ST2040	ST2045	ST1010	ST1030	
LNE336R01M1	19.05	14.3	9.525				▲	▲				▲	▲			△	△				△		△	
LNE446R01M	28.6	16	9.525				▲		▲			▲	▲			△	△			△		△		



重力铣削专用刀片

Heavy milling inserts

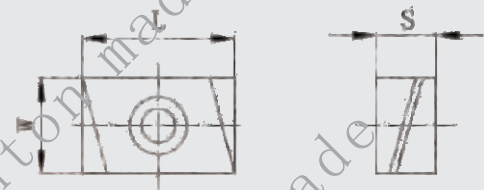

Type 型号	Dimension (mm) 基本尺寸						Coated Grade 涂层牌号								Uncoated Grade 非涂层牌号								
	L	W	S	D	R		ST2135	ST2230	ST2415	ST2410	ST3420	ST3430	ST1430	ST1420	ST1410	ST2020	ST2025	ST2030	ST2035	ST2040	ST2045	ST1010	ST1030
LSE323R02	15.875	9.525	4.76				▲		▲			▲	▲			△	△			△		△	
LSE323L02	15.875	9.525	4.76				▲		▲			▲	▲			△	△			△		△	
LSE434R01	19.05	14.3	6.35				▲		▲			▲	▲			△	△			△		△	
LSE434L01	19.05	14.3	6.35				▲		▲			▲	▲			△	△			△		△	
LSE435R100	19.05	13	8.5				▲		▲			▲	▲			△	△			△		△	
LSE446R01	28.6	14.3	9.525				▲		▲			▲	▲			△	△			△		△	
LSE446L01	28.6	14.3	9.525				▲		▲			▲	▲			△	△			△		△	
LSE346R01-M	24	14.3	9.525				▲		▲			▲	▲			△	△			△		△	
LSE446R01-M	28.6	16	9.525				▲		▲			▲	▲			△	△			△		△	

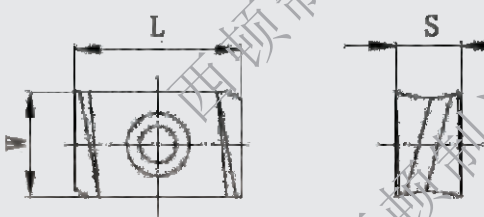

Type 型号	Dimension (mm) 基本尺寸						Coated Grade 涂层牌号								Uncoated Grade 非涂层牌号								
	L	W	S	D	R		ST2135	ST2230	ST2415	ST2410	ST3420	ST3430	ST1430	ST1420	ST1410	ST2020	ST2125	ST2030	ST2035	ST2040	ST2045	ST1010	ST1030
LPE435R100	19.05	14.3	8.5				▲		▲			▲	▲			△	△			△		△	
LPE446R100	28.6	16	9.525				▲		▲			▲	▲			△	△			△		△	



重力铣削专用刀片

Heavy milling inserts

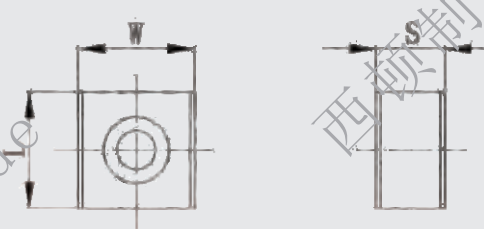

Type 型号	Dimension (mm) 基本尺寸						Coated Grade 涂层牌号								Uncoated Grade 非涂层牌号								
	L	W	S	D	R		ST2135	ST2230	ST2415	ST2410	ST3420	ST3430	ST1430	ST1420	ST1410	ST2020	ST2025	ST2030	ST2035	ST2040	ST2045	ST1030	
SNE33-01	9.525	9.525	4.76				▲		▲			▲	▲			△	△			△		△	
SNC44-60	12.7	12.7	6.35				▲		▲			▲	▲			△	△			△		△	
SNC55	15.875	15.875	7.9				▲		▲			▲	▲			△	△			△		△	
SNC55K02PH10*6	15.875	15.875	7.9				▲		▲			▲	▲			△	△			△		△	

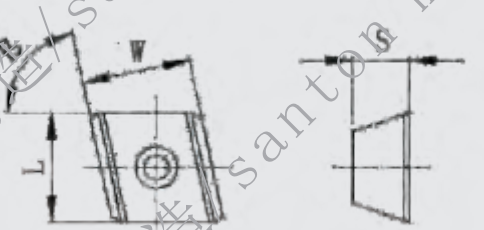

Type 型号	Dimension (mm) 基本尺寸						Coated Grade 涂层牌号								Uncoated Grade 非涂层牌号								
	L	W	S	β	D	R	ST2135	ST2230	ST2415	ST2410	ST3420	ST3430	ST1430	ST1420	ST1410	ST2020	ST2025	ST2030	ST2035	ST2040	ST2045	ST1010	ST1030
SPE33R01	11.1	11.1	4.76	80°			▲		▲			▲	▲			△	△			△		△	
SPE33R02	11.1	11.1	4.76	80°			▲		▲			▲	▲			△	△			△		△	
SPE440-102	15	15	6.35	80°			▲		▲			▲	▲			△	△			△		△	
SPE55R02	14.3	14.3	6.35	80°			▲		▲			▲	▲			△	△			△		△	
SPE55R03	14.3	12.7	6.35	78°			▲		▲			▲	▲			△	△			△		△	
SPE55R04	22.8	14.3	6.35	78°			▲		▲			▲	▲			△	△			△		△	



重力铣削专用刀片

Heavy milling inserts

JP

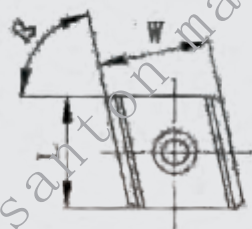

Type 型号	Dimension (mm) 基本尺寸						Coated Grade 涂层牌号						Uncoated Grade 非涂层牌号					
	L	W	S	β	D	R	ST2135	ST2230	ST2415	ST2410	ST3420	ST3430	ST1430	ST1420	ST1410	ST2020	ST2025	ST2030
JPE33R01	11.1	11.1	4.76	70°			▲		▲		▲	▲				△	△	

YC

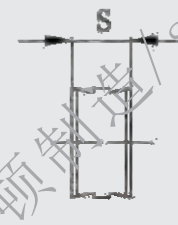
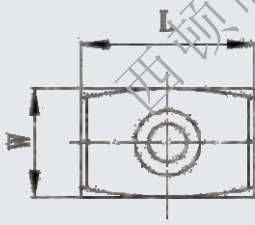

Type 型号	Dimension (mm) 基本尺寸						Coated Grade 涂层牌号						Uncoated Grade 非涂层牌号					
	L	W	S	D	R		ST2135	ST2230	ST2415	ST2410	ST3420	ST3430	ST1430	ST1420	ST1410	ST2020	ST2025	ST2030
YCE323-01	15.875	9.525	4.76				▲		▲		▲	▲				△	△	
YCE434-01	19.05	14.3	6.35				▲		▲		▲	▲				△	△	



重力铣削专用刀片

Heavy milling inserts

92.40

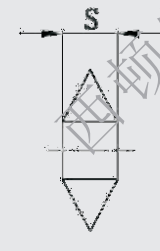
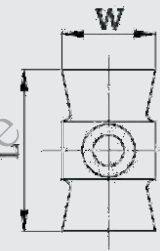
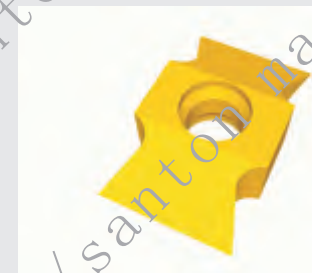

Type 型号	Dimension (mm) 基本尺寸						Coated Grade 涂层牌号						Uncoated Grade 非涂层牌号					
	L	W	S	D	R		ST2135	ST2230	ST2415	ST2410	ST3420	ST3430	ST1430	ST1420	ST1410	ST2020	ST2025	ST2030
92.40.001.04	15.875	9.525	4.76				▲		▲		▲	▲				△	△	
92.40.003.04	15.875	9.525	4.76				▲		▲		▲	▲				△	△	
92.40.101.04	19.05	12.7	6.35				▲		▲		▲	▲				△	△	
92.40.103.04	19.05	12.7	6.35				▲		▲		▲	▲				△	△	
92.40.203.04	28.6	14.3	9.525				▲		▲		▲	▲				△	△	
92.40.206.04	28.6	14.3	9.525				▲		▲		▲	▲				△	△	

2D

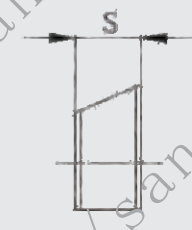
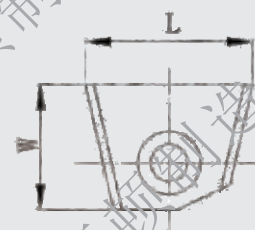

Type 型号	Dimension (mm) 基本尺寸						Coated Grade 涂层牌号						Uncoated Grade 非涂层牌号					
	L	W	S	D	R		ST2135	ST2230	ST2415	ST2410	ST3420	ST3430	ST1430	ST1420	ST1410	ST2020	ST2025	ST2030
ZDE324K08	15.875	9.525	6.35				▲		▲		▲	▲				△	△	
ZDE324K08T13	15.875	9.525	6.35				▲		▲		▲	▲				△	△	



主要生产设备简介

Main production facilities introduction

新型制粒机/New type granulator



模具库/Mould warehouse



全自动压力机/Full automatic pressing machine



低压烧结炉/HIP sintering furnace



精磨车间/Grinding workshop



质检车间/Quality check room



联系电话/TEL : +86-28-85739522 +86-28-85739369

17

电子邮箱/Email : sales_1@santoncc.com



成都西顿硬质合金有限公司

CHENGDU SANTON CEMENTED CARBIDE CO., LTD.

安全事项

硬质合金产品，硬而脆，搬运或装夹不当容易造成产品的损坏，请正确安装。

加工过程中也有可能会产生切削飞溅，且经常使用冷却液，所以请在加工过程中采取必要的安全措施，比如使用通风设备，配备设备防护罩，戴保护眼镜，穿工作服等。经过刃磨的刀片，刃刃比较锋利，装夹请注意保护好手。

Safety Precautions

Cemented carbide (hard metal) products are hard and brittle, easy to be damaged by improper handling or clamping. Please install correctly.

Cutting splatter may also occur during processing, and coolant is often used. Therefore, please take necessary safety measures in the course of machining, such as employing ventilation equipment, using equipment protective cover, wearing protective glasses and working clothes, etc. Please make sure that hands should be protected well when clamping grinded inserts due to sharper cutting edges.

成都西顿硬质合金有限公司郑重承诺：

我们的产品售价不是最低的，但是我们的产品性价比是最高的。

我们像客户一样重视售价，但我们更重视产品品质。

Chengdu santon cemented carbide co., ltd. seriously commits :

The price of our products may not be the lowest, but our products are most cost efficient.

We value prices as much as our customers do, but we pay more attention to the quality of our products.

样本中的产品数据和实物如有变更，本公司不便另行通知，请谅解！

如产品图片与实物不符，以实物为准。

If any revision of the technical data and pictures in the catalog, excuse us not giving further notification. Please refer to the sample if there is a difference between the picture and sample.



联系电话/TEL : +86-28-85739522 +86-28-85739369

18

电子邮箱/Email : sales_1@santoncc.com



携手并进 共创未来

一流的人才团队，
卓越的品质追求，
持续的创新驱动，
完善的市场服务。
为用户创造更大价值，
让员工与企业共成长。

Co-create the prosperous future hand in hand
First-class talent team,
Excellent quality pursuit,
Continuous innovation drive,
Perfect marketing services,
Create more value for users,
Let employees and our company grow together.

